



## F6

Hi-end

Mid-Bass Speaker

Unit: mm

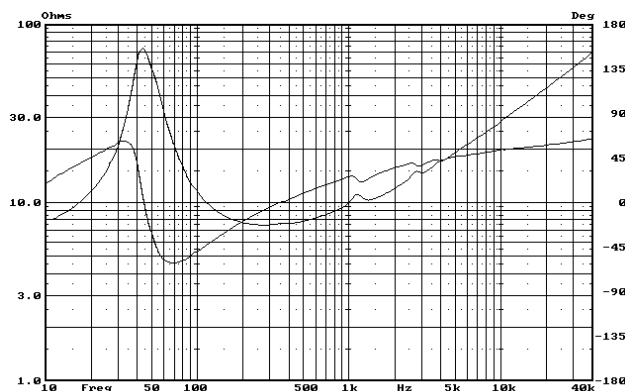
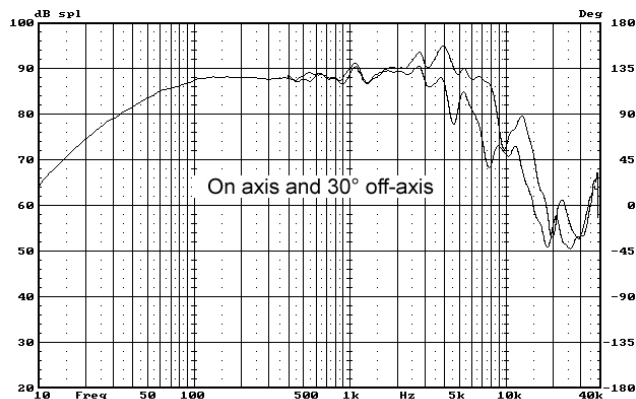
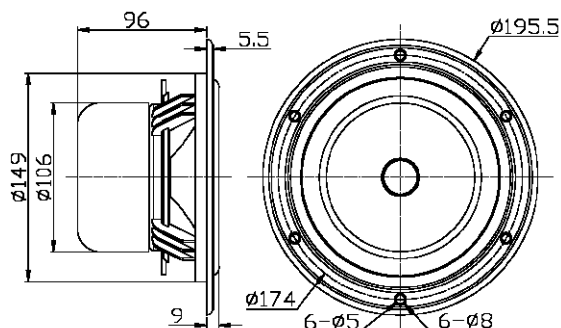

Swans' well-known mid-woofer speaker unit in the industry.

The Swans M1.2 speaker with F6 has won numerous praises at home and abroad!

Small/Thiele parameter optimization design technology leading the industry-convenient cabinet design.

Yellow German Kevlar/natural fiber ultra-light and high-strength integrated diaphragm-natural and accurate sound / German special fatigue-resistant and high-loss natural rubber folding ring-strong absorption of excess vibration energy / high permeability, high stability and centering support made in the UK-improved Para-state air compression characteristics / linear frequency phase correction design-wide and flat frequency response / fully enclosed dual-magnet high-energy antimagnetic magnetic circuit system-dynamic linear drive source / HiVi's unique symmetrical magnetic field (SMD) drive technology-high sound pressure and low distortion output / Finite element precision computer simulation design integrated high-density aluminum frame-eliminate harmful resonance / high-power high temperature resistant Kapton voice coil frame without eddy current loss-guarantee of high-quality bass.

Voice characteristics:

Naturally accurate, highly analytical, full of vitality and dynamic! It is suitable for the low frequency unit in the Hi-Fi two-way phase inverted speaker system and the midrange unit in the three-way system.

Parameter			
Item	Symbol	Figure	unit
Rated Impedance	Z	8	Ω
Resonant Frequency	Fs	45	Hz
Rated Power	Pnom	45	W
Max Power	Pmax	90	W
Sensitivity(2.83V/1m)	E	88	dB
Weight	W	2.1	kg
Voice Coil			
Voice Coil Diameter	Ø	25	mm
DC Resistance	Re	6.5	Ω
Voice Coil Width	H	14.5	mm
Voice Coil Material	High temperature resistance SV wire		
Voice Coil Frame	High temperature resistance Kapton		
Magnetic Circuit			
Magnetic Circuit	Shielded antimagnetic magnetic circuit		
Magnetic Material	High performance ferrite		
BL	BL	9.0	N/A
Magnetic Gap Height	He	6.0	mm
Maximum linear displacement	Xmax	4.3	mm
Small/Thiele Parameter			
compliance	Cms	658	uM/N
Mechanical Q value	Qms	3.91	-
Electric Q value	Qes	0.38	-
Total Q value	Qts	0.35	g
Vibration Quality	Mms	18.3	
Equivalent Capacity	Vas	16.4	L
Reconmand Cabinet Parameter			
Cabinet Type	RF		
Reconmand Cabinet Net Capacity	Vb	15	L
Inverter Turning Frequency	Fb	45	Hz
-3dB Frequency(Free Field )	F3	42	Hz